

## Ground Floor Units

BY TRILUM

| BLOCK | APARTMENT NO | TYPE   | FLOOR            | AREA / m <sup>2</sup> |          |                 | FEATURES                    | VIEW      | PRICE    | AVAILABILITY  |
|-------|--------------|--------|------------------|-----------------------|----------|-----------------|-----------------------------|-----------|----------|---------------|
|       |              |        |                  | TOTAL                 | INTERNAL | BALCONY/TERACCE |                             |           |          |               |
| A     | 1            | Shop   | Ground           | ---                   | ---      | ---             | ---                         | ---       | *        | ---           |
| A     | 2            | Shop   | Ground           | ---                   | ---      | ---             | ---                         | ---       | *        | ---           |
| A     | 3            | Shop   | Ground           | ---                   | ---      | ---             | ---                         | ---       | *        | ---           |
| A     | 4            | Shop   | Ground           | ---                   | ---      | ---             | ---                         | ---       | *        | TRICON OFFICE |
| B     | 1            | Shop   | Ground           | ---                   | ---      | ---             | ---                         | ---       | *        | ---           |
| C     | 1            | Studio | Ground           | 38                    | 31.7     | 12              | Open Terrace                | Pool View | *        | SOLD          |
| C     | 2            | Studio | Ground           | 38                    | 31.7     | 11              | Open Terrace                | Pool View | *        | SOLD          |
| C     | 3            | 1+1    | Ground           | 55                    | 45       | 25              | Open Terrace                | Pool View | *        | SOLD          |
| C     | 4            | 1+1    | Ground           | 55                    | 45       | 11              | Open Terrace                | Pool View | *        | SOLD          |
| C     | 5            | 1+1    | Ground           | 55                    | 45       | 10              | Open Terrace                | Pool View | *        | SHOWHOUSE     |
| C     | 6            | 1+1    | Ground           | 55                    | 45       | 10              | Open Terrace                | Pool View | *        | SOLD          |
| C     | 7            | 1+1    | Ground           | 55                    | 45       | 6               | Open Terrace                | Pool View | *        | RESERVED      |
| C     | 8            | 1+1    | Ground           | 55                    | 45       | 11              | Open Terrace                | Pool View | *        | SOLD          |
| C     | 9            | Studio | Ground           | 38                    | 31.7     | 17              | Open Terrace                | Pool View | *        | SOLD          |
| D     | 1            | 2+2    | Ground and First | 64                    | 58       | 27              | Open Terrace                | Pool View | *        | SOLD          |
| D     | 2            | 1+1    | Ground           | 55                    | 45       | 12              | Open Terrace                | Pool View | *        | SOLD          |
| D     | 3            | 1+1    | Ground           | 55                    | 45       | 6               | Open Terrace                | Pool View | *        | SOLD          |
| D     | 4            | 1+1    | Ground           | 55                    | 45       | 15              | Open Terrace                | Pool View | *        | SOLD          |
| D     | 5            | 1+1    | Ground           | 55                    | 45       | 11              | Open Terrace                | Pool View | *        | SOLD          |
| D     | 6            | 1+1    | Ground           | 55                    | 45       | 16              | Open Terrace                | Pool View | *        | SOLD          |
| D     | 7            | Studio | Ground           | 38                    | 31.7     | 22              | Open Terrace                | Pool View | *        | SOLD          |
| E     | 1            | Studio | Ground           | 38                    | 31.7     | 15              | Open Terrace                | Pool View | *        | SOLD          |
| E     | 2            | 2+1    | Ground           | 94                    | 81.45    | 23              | Open terrace Corner         | Pool View | *        | SOLD          |
| E     | 3            | 2+1    | Ground           | 70                    | 58.7     | 30              | Open Terrace Private Garden | Pool View | £180,000 | AVAILABLE     |
| E     | 4            | 1+1    | Ground           | 55                    | 45       | 22+22           | Open Terrace Private Garden | Pool View | *        | SOLD          |
| E     | 5            | 2+1    | Ground           | 70                    | 58.7     | 37+32           | Open Terrace Private Garden | Pool View | £180,000 | AVAILABLE     |
| F     | 1            | 2+1    | Ground           | 70                    | 58.7     | 36+34           | Open Terrace Private Garden | Pool View | £180,000 | AVAILABLE     |
| F     | 2            | 1+1    | Ground           | 55                    | 45       | 22+22           | Open Terrace Private Garden | Pool View | *        | SOLD          |
| F     | 3            | 2+1    | Ground           | 70                    | 58.7     | 29+27           | Open Terrace Private Garden | Pool View | *        | SOLD          |
| F     | 4            | Studio | Ground           | 38                    | 31.7     | 13+24           | Open Terrace Private Garden | Pool View | *        | SOLD          |

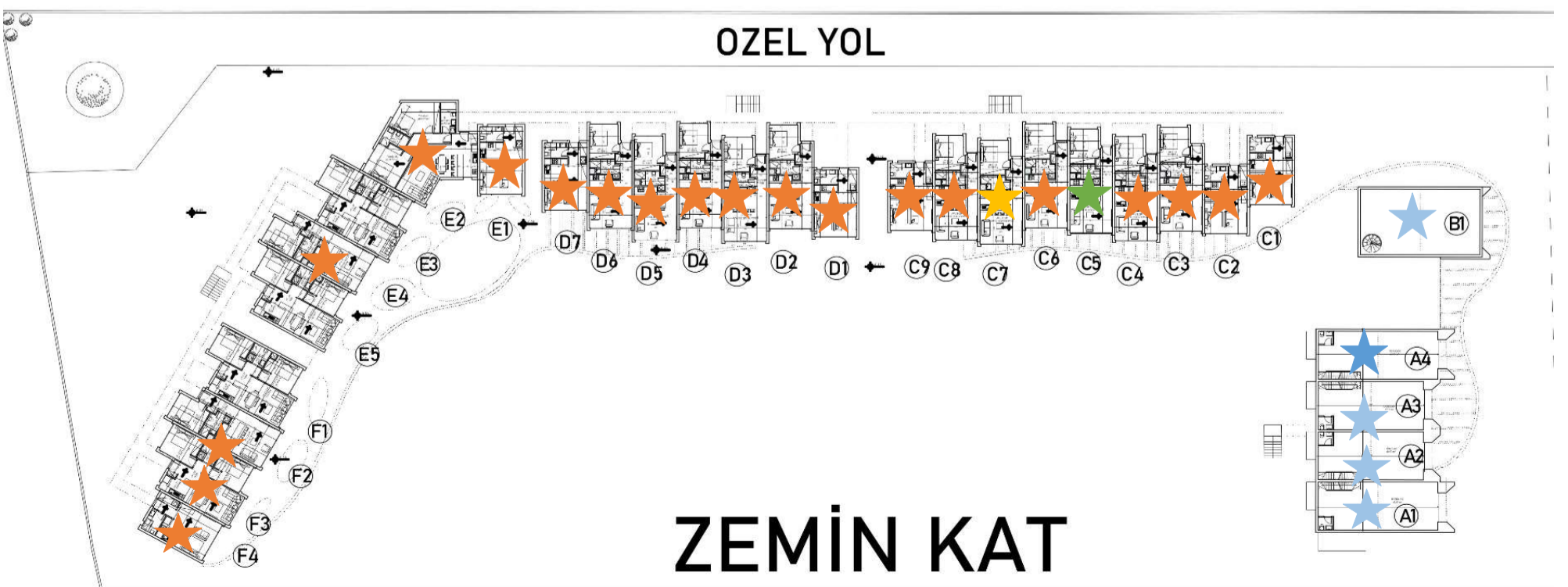

## - First Floor Units

BY TRICON

| BLOCK | APARTMENT NO | TYPE        | FLOOR | AREA / m <sup>2</sup> |          |                 | FEATURES                                       | VIEW                          | PRICE    | AVAILABILITY |
|-------|--------------|-------------|-------|-----------------------|----------|-----------------|--|-------------------------------|----------|--------------|
|       |              |             |       | TOTAL                 | INTERNAL | BALCONY/TERACCE |  |                               |          |              |
| A     | 5            | Shop        | First | ---                   | ---      | ---             | ---  | ---                           | *        | ---          |
| A     | 6            | Shop        | First | ---                   | ---      | ---             | ---  | ---                           | *        | ---          |
| A     | 7            | Shop        | First | ---                   | ---      | ---             | ---  | ---                           | *        | ---          |
| A     | 8            | Shop        | First | ---                   | ---      | ---             | ---  | ---                           | *        | ---          |
| C     | 10           | Studio-Loft | First | 61                    | 47.1     | 27.3            | Roof Terrace                                   | Pool View<br>Partial Sea View | *        | SOLD         |
| C     | 11           | Studio-Loft | First | 61                    | 47.1     | 27.3            | Roof Terrace                                   | Pool View<br>Partial Sea View | *        | SOLD         |
| C     | 12           | 1+2 Loft    | First | 70                    | 57.1     | 20+25           | Loft Terrace<br>Roof Terrace                   | Pool View<br>Partial Sea View | *        | SHOWHOUSE    |
| C     | 13           | 1+2 Loft    | First | 70                    | 57.1     | 20+25           | Loft Terrace<br>Roof Terrace                   | Pool View<br>Partial Sea View | £210,000 | AVAILABLE    |
| C     | 14           | 1+2 Loft    | First | 70                    | 57.1     | 20+25           | Loft Terrace<br>Roof Terrace                   | Pool View<br>Partial Sea View | £210,000 | AVAILABLE    |
| C     | 15           | 1+2 Loft    | First | 70                    | 57.1     | 20+25           | Loft Terrace<br>Roof Terrace                   | Pool View<br>Partial Sea View | £210,000 | AVAILABLE    |
| C     | 16           | 1+2 Loft    | First | 70                    | 57.1     | 20+25           | Loft Terrace<br>Roof Terrace                   | Pool View<br>Partial Sea View | £210,000 | AVAILABLE    |
| C     | 17           | 1+2 Loft    | First | 70                    | 57.1     | 20+25           | Loft Terrace<br>Roof Terrace                   | Pool View<br>Partial Sea View | £210,000 | AVAILABLE    |
| C     | 18           | Studio-Loft | First | 61                    | 47.1     | 27.3            | Roof Terrace                                   | Pool View<br>Partial Sea View | *        | SOLD         |
| D     | 8            | 1+2 Loft    | First | 70                    | 57.1     | 20+25           | Loft Terrace<br>Roof Terrace                   | Pool View<br>Partial Sea View | £210,000 | AVAILABLE    |
| D     | 9            | 1+2 Loft    | First | 70                    | 57.1     | 20+25           | Loft Terrace<br>Roof Terrace                   | Pool View<br>Partial Sea View | £210,000 | AVAILABLE    |
| D     | 10           | 1+2 Loft    | First | 70                    | 57.1     | 20+25           | Loft Terrace<br>Roof Terrace                   | Pool View<br>Partial Sea View | £210,000 | AVAILABLE    |
| D     | 11           | 1+2 Loft    | First | 70                    | 57.1     | 20+25           | Loft Terrace<br>Roof Terrace                   | Pool View<br>Partial Sea View | £210,000 | AVAILABLE    |
| D     | 12           | 1+2 Loft    | First | 70                    | 57.1     | 20+25           | Loft Terrace<br>Roof Terrace                   | Pool View<br>Partial Sea View | £210,000 | AVAILABLE    |
| D     | 13           | Studio-Loft | First | 61                    | 47.1     | 27.3            | Roof Terrace                                   | Pool View<br>Partial Sea View | *        | SOLD         |
| E     | 6            | Studio-Loft | First | 61                    | 47.1     | 27.3            | Roof Terrace                                   | Pool View<br>Partial Sea View | *        | SOLD         |
| E     | 7            | 1+2 Loft    | First | 94                    | 79       | 23+25           | First Floor Open Terrace<br>Loft Floor Terrace | Pool View<br>Sea View         | £250,000 | AVAILABLE    |
| E     | 8            | 1+2 Loft    | First | 72                    | 59.25    | 10+18           | First Floor Open Terrace<br>Loft Terrace       | Pool View<br>Sea View         | £200,000 | AVAILABLE    |
| E     | 9            | 1+2 Loft    | First | 70                    | 57.1     | 20+25           | Loft Terrace<br>Roof Terrace                   | Pool View<br>Sea View         | £210,000 | AVAILABLE    |
| E     | 10           | 1+2 Loft    | First | 72                    | 59.25    | 10+18           | First Floor Open Terrace<br>Loft Terrace       | Pool View<br>Sea View         | £200,000 | AVAILABLE    |
| F     | 5            | 1+2 Loft    | First | 72                    | 59.25    | 10+18           | First Floor Open Terrace<br>Loft Terrace       | Pool View<br>Sea View         | £200,000 | AVAILABLE    |
| F     | 6            | 1+2 Loft    | First | 70                    | 57.1     | 20+25           | Loft Terrace<br>Roof Terrace                   | Pool View<br>Sea View         | £210,000 | AVAILABLE    |
| F     | 7            | 1+2 Loft    | First | 72                    | 59.25    | 10+18           | First Floor Open Terrace<br>Loft Terrace       | Pool View<br>Sea View         | £200,000 | AVAILABLE    |
| F     | 8            | Studio-Loft | First | 61                    | 47.1     | 27.3            | Roof Terrace                                   | Pool View<br>Sea View         | *        | SOLD         |

### OZEL YOL

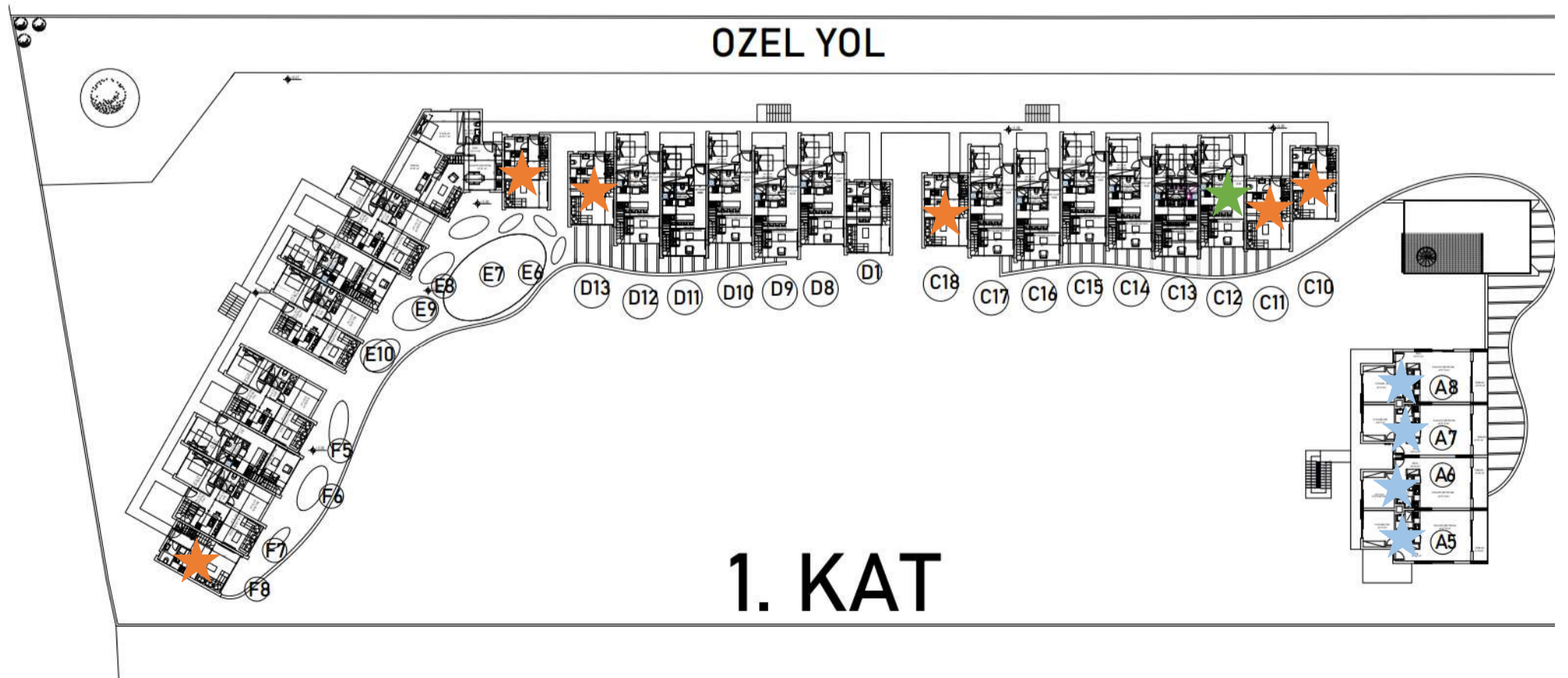

## 1. KAT